

# ELEVATING THE BENCHMARK FOR QUALITY



TX-5310

TX-5410 MFP Z36



 TX-5410 Max. Print Width	 TX-5310 Max. Print Width	 LUCIA TD ink	 FINE Full-photolithography Inkjet Nozzle Engineering	 L-COA PRO	 5pl Ink droplet size	 Line Accuracy: +/- 0.1% or less	 Multifunction Roll System
 100 Sheets High Capacity Stacker	 MFP	 Connectivity	 4.3" Colour LCD Touch Panel	 Auto Media Loading	 AUTO Auto Media Detection	 AUTO Estimation of Remaining Media	 500GB Encrypted HDD

The new Canon imagePROGRAF TX series printers are engineered to deliver outstanding quality, high productivity and operability. Equipped with unique class-leading print technologies and security features, TX series is the ideal solution for all CAD drawings, GIS, perspective rendering and poster printing.



TX-5310

TX-5410

TX-5310 MFP Z36

TX-5410 MFP Z36



CORE TECHNOLOGIES



HIGH-PRECISION MECHANICAL PLATFORM

The unibody structure is engineered to provide strong and stable platform, allowing print head to scan at high speed while maintaining precise ink droplet placement for high-quality print.

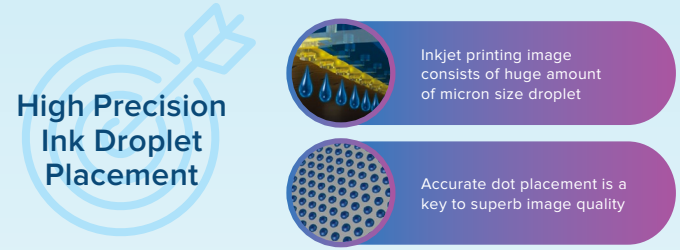

HIGH-SPEED IMAGE PROCESSING ENGINE



PRINTING TECHNOLOGY

The TX series employs FINE print head, PF-06, which is 1.07 inch wide with 6-colour channels and 15,360 nozzles. The improved thermal diffusion provides better uniformity of ink density and colours, while non-firing nozzles detection will automatically compensate for nozzle blockage, ensuring best quality on every print.



The LUCIA TD 5-colour all pigment ink is developed to produce high-quality printing for a wide range of applications such as drawings and posters on plain paper, posters and graphics on coated paper and glossy paper, and printing on water-resistant poster paper.

Simultaneous use of black and matte black inks produce text and lines that are dense and crisp with minimal feathering.

The LUCIA TD ink system gives vibrant colours in poster printing. It has excellent colour fastness to minimise colour fading and exhibits superior outdoor weather resistance with water resistant media.

INCREASE YOUR PRODUCTIVITY AND WORKFLOW EFFICIENCY

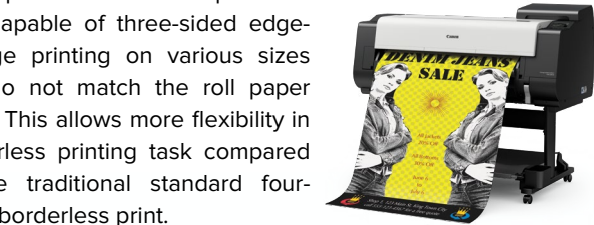
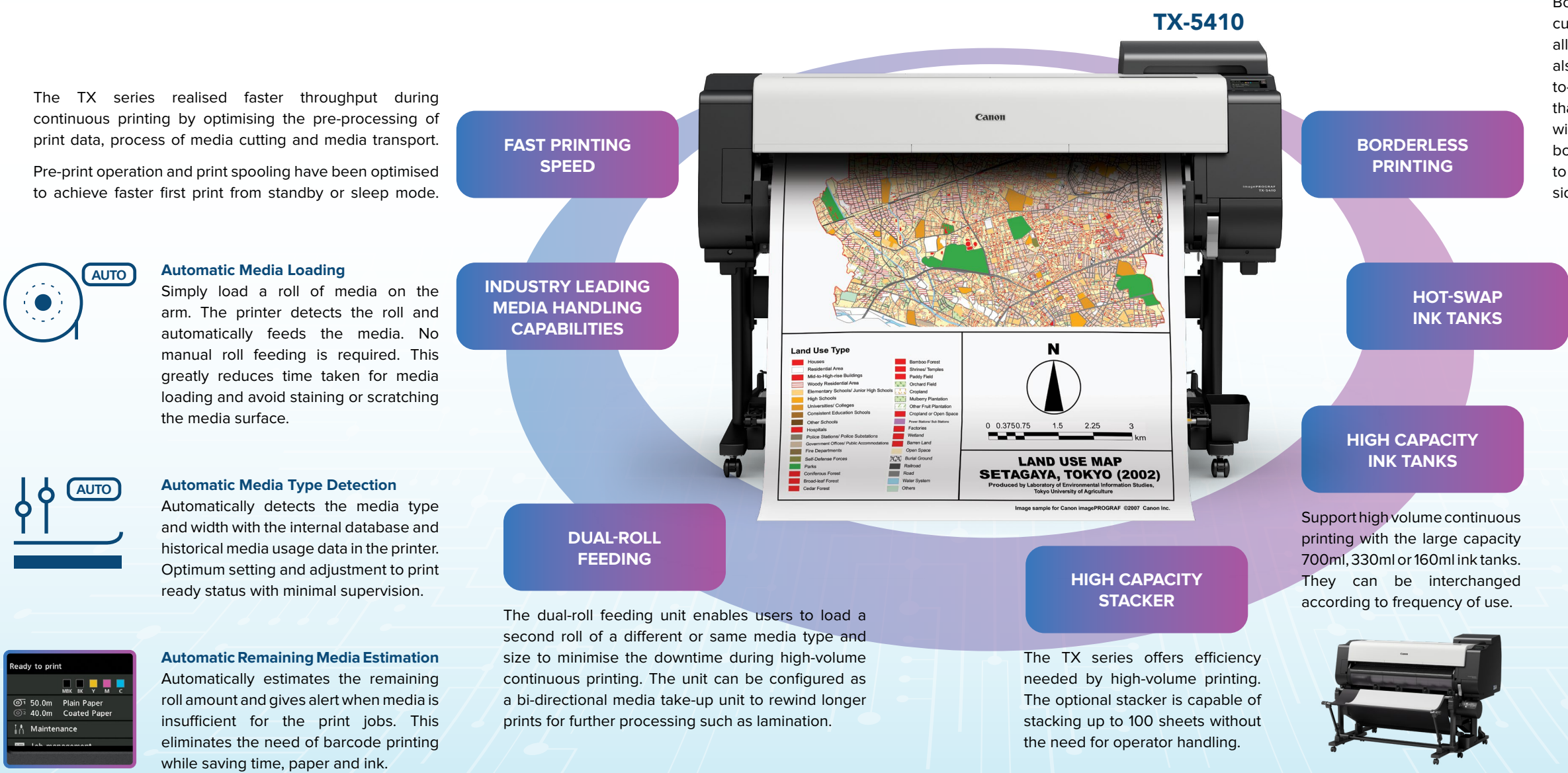

# SECURE YOUR PRINT ENVIRONMENT

The TX series complies with the Advanced Encryption Standard (256-bit) established by the U.S. National Institute of Standards and Technology (NIST).



## SECURE PRINTING

Keep confidential information secure by protecting the print job with passcode and delay print release until user enters passcode at the operation panel.



## SECURE PROTOCOLS

Data are transmitted securely through secured protocols such as IPSec, SNMPv3, SSL/TLS and 802.1x authentication.

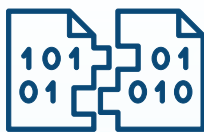

## HARD DISK DRIVE ENCRYPTION

Print jobs and data are in safe hands with the TX series, they are protected at all times by secured encryption.



## FULL ADMINISTRATOR CONTROL

Administrator control makes it possible to restrict operation panel access and printer functionality according to users' level of security requirements.



## SECURE DISK & FILE ERASURE

Data erasure overwrites and destroys overwritten data to ensure complete data destruction on the printer hard disk, providing complete data security.

# MANAGING YOUR PRINT JOBS HAS NEVER BEEN EASIER

Canon software applications are designed specifically to keep each print job on track and improve your workflow and productivity.

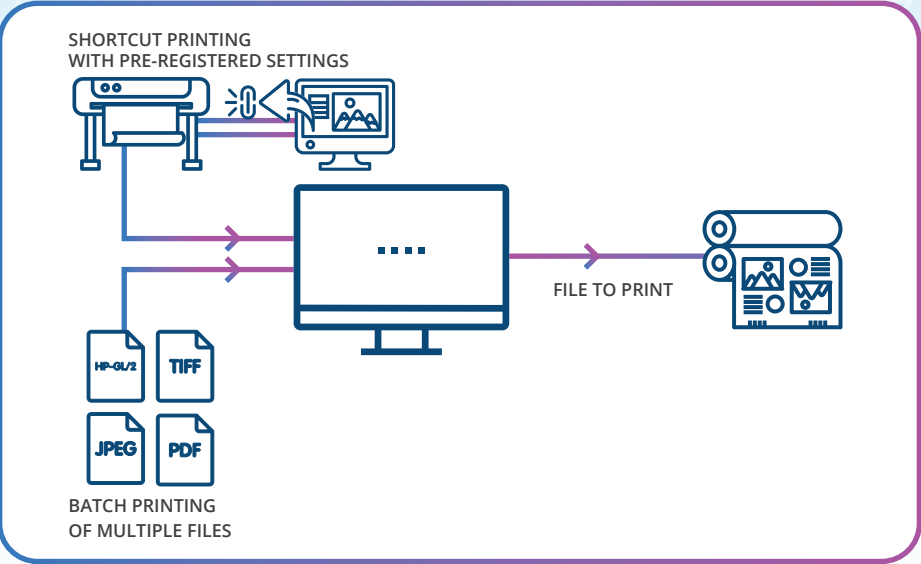

## DIRECT PRINT PLUS

The newly developed print job submission tool makes workflow simpler and more efficient with features including shortcut printing, batch printing of multiple files, nesting and print job progress monitoring.

## CPP DRIVER SELECT & PUBLISHER SELECT



The new TX series enable a smoother workflow integration and management for existing Canon Production Printing (CPP) users with support of CPP Driver Select and Publisher Select.

## POSTERARTIST LITE



Canon's PosterArtist Lite software lets you design and print professional looking posters with over 1,300 templates, photos and clipart to suit a wide variety of business environments. Creating head turning posters or signs has never been easier.

## FREE LAYOUT PLUS



Free Layout plus, a print utility that allows users to tile, nest and create custom layouts before printing.

## CANON PRINT INKJET/SELPHY



The Canon PRINT Inkjet/SELPHY app connects your mobile device wirelessly to TX series to print, scan and copy. It also works as a portal to manage your printer settings and monitor your printer status for a seamless printing experience.

## ACCOUNTING MANAGER



Accounting Manager is ideal for businesses looking to track printing costs based on the cost of media and ink.

## MEDIA CONFIGURATION TOOL



Simplifies media management for Canon and third party media, allowing you to customize media in both the driver and printer for optimum print result.

## DEVICE MANAGEMENT CONSOLE



Device Management Console effectively manages multiple printers, monitoring activities such as error messages and printer information like ink status and status of calibrations.

## imageRUNNER ADVANCE DIRECT ENLARGEMENT COPY



Scan-to-Print using an imageRUNNER to scan images and print directly to TX series printers.



# imagePROGRAF MFP SOLUTION

The new TX series MFP solution provides maximum performance in scanning and copying with speed and precision while keeping its footprint minimal.

TX-5410 MFP Z36

TX-5310 MFP Z36

Scanner is manufactured by U.K. - based Global Scanning UK Ltd.

## ALL NEW COMPACT DESIGN

The new Z36 scanner is designed from the ground up to better integrate with the new TX series printers. Lightweight and compact, this small footprint scanner is perfect for any office environment.

## PARALLEL PROCESSING OF SCANNING AND PRINTING

Parallel processing significantly improves productivity and efficiency by performing print and scan operation simultaneously.

## NEW SYSTEM CONTROLLER

The large 15.6” touchscreen panel system controller makes it easy to perform printing settings and preview before printing. Printer information such as media and ink status can be easily accessed via the system controller. Its embedded OS adds a layer of reliability and stability to the performance of the system controller.

## SMARTWORKS MFP V6 WITH ABUNDANT FEATURES

The new SmartWorks MFP scanning software simplifies large format scanning and copying with intuitive user interface and abundant of image enhancement features such as de-skew, white point, colour reversal of diazo print and restoration of deteriorated original images, which is useful for archiving old drawings.

\*TX-5410 MFP Z36 is a combination of TX-5410 printer and Z36 scanner.  
\*TX-5310 MFP Z36 is a combination of TX-5310 printer and Z36 scanner.

## SINGLE SENSOR, DUAL LED TECHNOLOGY

Single sensor covers full width ensures the finest text are reproduced without misalignment. Bi-directional illumination from dual LED reduces shadowing at creases or folds, ensuring high quality scanned image.

## DIVERSE MEDIA SUPPORT

Front entry - rewind to front path makes it convenient for regular scanning of plain paper document, while the straight-through paper path accepts scan documents up to 1 mm in thickness.



## SPECIFICATIONS

PRINTER		TX-5410		TX-5310	
Printer Type		5-Colour 44" (1,118 mm)		5-Colour 36" (914 mm)	
Number of Nozzles		15,360 nozzles (MBK: 5,120 nozzles; BK, C, M, Y: 2,560 nozzles each)			
Max. Print Resolution		2400 × 1200 dpi			
Nozzle Pitch		1200 dpi (2 lines)			
Line Accuracy *1		± 0.1 % or less			
Min. Ink Droplet Size		5 pl			
Ink Capacity	Sales Ink	160 ml / 330 ml / 700 ml (MBK, BK, C, M, Y)			
	Bundled Starter Ink	330 ml (MBK, BK, C, M, Y)		330 ml (MBK) / 160 ml (BK, C, M, Y)	
Ink Type		Pigment ink			
Printer Languages		SG Raster (Swift Graphic Raster), HP-GL/2, HP RTL, PDF (Ver. 1.7), JPEG (Ver. JFIF1.02)			
Print Solutions		Apple AirPrint, Direct Print Plus, Direct Print & Share, CPP Driver Select & Publisher Select, AutoCAD Optimized Printer Driver, Easy-PhotoPrint Editor, Canon PRINT Inkjet/SELPHY, Canon Print Service, Free Layout plus, PosterArtist Lite, imageRUNNER ADVANCE Direct Enlargement Copy			
Management Solutions		Media Configuration Tool, Accounting Manager, Device Management Console,Quick Utility Box			
Interface (Built-in)	Standard	Hi-Speed USB, Full Speed (12 Mbit/sec), Hi-Speed (480 Mbit/sec), Bulk transfer, Series B (4 pins), USB Memory (Direct Print)			
	Network	IEEE 802.3 10base-T, IEEE 802.3u 100base-TX/Auto-Negotiation, IEEE 802.3ab 1000base-T/Auto-Negotiation, IEEE 802.3x Full Duplex, SNMP, HTTP, FTP, TCP/IP (IPv4/IPv6)			
	Wireless LAN	IEEE802.11 b/g/n, WEP (64/128bit), WPA-PSK (TKIP/AES), WPA2-PSK (TKIP/AES)			
Memory		Standard: 128 GB (Physical: 2 GB)			
Hard Disk		500 GB (Encrypted)			
PRINT SPEED *2 (A0 SIZE)					
Plain Paper	CAD Drawings	34 sec [Fast (Custom Q5)] 37 sec [Fast] 1 min 4 sec [Standard]			
	Poster	37 sec [Fast (Custom Q5)] 42 sec [Fast] 1 min 15 sec [Standard]			
Heavyweight Coated Paper HG	Poster	1 min 38 sec [Fast] 2 min 33 sec [Standard]			
Glossy Photo Paper HG 170	Poster	2 min 59 sec [Fast] 5 min 44 sec [Standard]			
MEDIA HANDLING					
Media Width	Roll Paper / Cut Sheet	152.4 ~ 1,118 mm		152.4 ~ 917 mm	
Media Thickness	Roll Paper / Cut Sheet	0.07 ~ 0.8 mm			
Min. Printable Length	Roll Paper	101.6 mm*3			
	Cut Sheet	203.2 mm			
Max. Printable Length	Roll Paper	18 m*4			
	Cut Sheet	1.6 m			
Max. Roll Outer Diameter		170 mm or less			
Media Feed Method	Roll Paper / Cut Sheet	Front Load, Front Output *5			
Media Take-up Unit *6		Dual directions rolling take-up			
Borderless Printing (Roll Paper only, standard & custom sizes)	Printable Media Width	152.4 ~ 1,118 mm		152.4 ~ 917 mm	
Margins	Recommended Area	Roll Paper - Top: 20 mm, Bottom: 3 mm, Side: 3 mm Cut Sheet - Top: 20 mm, Bottom: 31 mm, Side: 3 mm (Apple AirPrint) Cut Sheet - Top: 20 mm, Bottom: 20 mm, Side: 3 mm (Others)			
	Printable Area	Roll Paper - Top: 3 mm, Bottom: 3 mm, Side: 3 mm Roll Paper - Top: 0 mm, Bottom: 0 mm, Side: 0 mm (Borderless Print) Cut Sheet - Top: 3 mm, Bottom: 12.7 mm, Side: 3 mm (Apple AirPrint) Cut Sheet - Top: 3 mm, Bottom: 20 mm, Side: 3 mm (Others)			
Media Output	Multi-Position Basket	Standard Position: 1 sheet Flat Position: 10 sheets glossy paper / 20 sheets coated or plain paper (A2 Landscape)			
	Stacker*7	Standard Position: 10 sheets plain paper (A0) Folding Position: 20 sheets plain paper (A0) / 100 sheets uncoated paper (A0) Stacking Position: 100 sheets uncoated / plain paper (A1)			
DIMENSIONS & WEIGHT *8					
Packaged Dimensions (W x D x H) Weight	Main Unit + Stand + Basket + Pallet	1820 x 915 x 1061 mm 165 kg		1606 x 903 x 1061 mm 153 kg	
	Stacker	1464 x 906 x 291 mm 25 kg		1249 x 906 x 291 mm 24 kg	
	Roll Unit	1727 x 562 x 461 mm 30 kg		1524 x 562 x 461 mm 26 kg	
Dimensions (W x D x H) Weight	Main Unit + Stand + Basket	1593 x 984 x 1168 mm (Basket Open) 1593 x 766 x 1168 mm (Basket Closed) 114 kg*9		1390 x 984 x 1168 mm (Basket Open) 1390 x 766 x 1168 mm (Basket Closed) 105 kg*9	
	Main Unit + Roll Unit + Stand + Stacker	1593 x 1188 x 1168 mm (Basket Open) 1593 x 1122 x 1168 mm (Basket Closed) 146 kg*9		1390 x 1188 x 1168 mm (Basket Open) 1390 x 1122 x 1168 mm (Basket Closed) 136 kg*9	
	Roll Unit	1577 x 336 x 318 mm 20 kg		1374 x 336 x 318 mm 19 kg	
POWER AND OPERATING REQUIREMENTS					
Power Supply		AC 100 - 240 V, 50-60 Hz			
Power Consumption	Operation	116 W or less		115 W or less	
	Sleep Mode	2.0 W or less			
	Power OFF	0.3 W or less			
Operational Environment	Temperature	15 - 30 °C			
	Humidity	10 - 80 % RH (no dew condensation)			
Acoustic	Power *9	Operation: Approx. 69 dB			
	Pressure *9	Operation: Approx. 51 dB (A) Standby: 35 dB (A) or less			
OPTIONS					
Roll Unit		RU-42		RU-32*10	
Stacker		SS-41		SS-31	
2" / 3" Roll Holder		RH2-46		RH2-34	
CONSUMABLES					
Ink Tank		PFI-8110 (160 ml) / PFI-8310 (330 ml) / PFI-8710 (700 ml)			
Print Head		PF-06			
Cutter Blade		CT-07			
Maintenance Cartridge		MC-30			

\*1 User adjustments required. Printing environment and media must match those used for the adjustments. Paper required: Plain paper, CAD tracing paper, coated paper, CAD translucent matte film only.  
\*2 Time taken to print one page does not include time required for data processing, data transfer and pre-printing operations.  
\*3 Minimum printable length for cloth, canvas, tracing paper and translucent matte film media is 200 mm.  
\*4 Varies according to the OS and application.  
\*5 For cut sheet, manual feed using media locking lever.  
\*6 Optional accessory for TX-5410.  
\*7 Optional accessory for TX-5310 and TX-5410.  
\*8 Include roll holder set, exclude ink and print head.  
\*9 Measured using ISO 7779 standard by using 42" plain paper for TX-5410 or 36" plain paper for TX-5310, standard mode and line drawing / text mode.  
\*10 RU-32 is a required accessory for TX-5310.

# imagePROGRAF

## TX Series

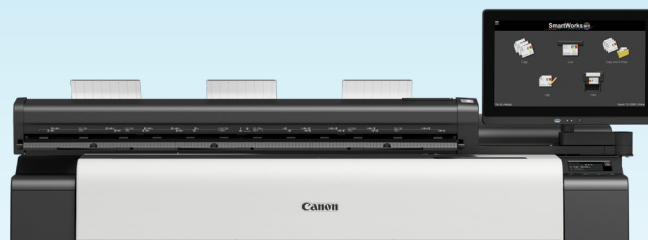

SCANNER <sup>*11</sup>		Z36
Scan Width		36" (914 mm)
Min. Scan Width		6" (150 mm)
Max. Scan Length	JPEG / PDF	8 m
	TIFF	15.2 m
Max. Copy Speed (inch/sec) <sup>*12</sup>	24-bit Colour	200 dpi: 6 ips 300 dpi: 4 ips 600 dpi: 2 ips
	8-bit Greyscale & Monochrome	200 dpi: 13 ips 300 dpi: 8.6 ips 600 dpi: 4.3 ips
Max. Scan Speed (inch/sec) <sup>*12</sup>	24-bit Colour	200 dpi: 3 ips 300 dpi: 2 ips 600 dpi: 2 ips
	8-bit Greyscale & Monochrome	200 dpi: 13 ips 300 dpi: 8.6 ips 600 dpi: 4.3 ips
Optical Resolution		1200 dpi
Document Handling <sup>*13</sup>		Front Load, Rear Output
Max. Document Thickness <sup>*14</sup>		1 mm
System Controller	Operating System	Windows 10 Enterprise LTSC 64 bit
	Processor	Intel Pentium G5400T
	Hard Disk	256 GB (Solid State Drive)
	Memory	8 GB (DDR 4)
	Display	15.6" multi-touch colour display
Software Included		SmartWorks MFP V6
Scan Format		PDF, Multipage PDF, JPEG, TIFF, DWF
Dimensions (W x D x H) <sup>*15</sup>		1056 x 251 x 156 mm
Weight	Scanner	7.8 kg
	System Controller	2.5 kg
Power Consumption (Scanner)	Operation <sup>*16</sup>	22.7 W (Colour) / 23.3 W (Greyscale)
	Sleep Mode	0.2 W
	Standby	12.4 W
Power Consumption (System Controller)	Operation	50.1 W
	Sleep Mode	1.7 W
	Standby	7.5 W

\*11 Scanner is manufactured by U.K. - based Global Scanning UK Ltd. Scanner is supplied with TX-5310 MFP Z36 and TX-5410 MFP Z36.

\*12 The scan rate is proportional across the full range of resolutions supported by the scanner. Actual scan times and quoted top speeds will depend on the host performance and are not guaranteed for all media types. Scan times quoted are the maximum for true 200 x 200 dpi image capture.

\*13 Thicker documents must be flexible and the document return guides removed and may require additional support. Some media should be scanned at reduced speeds. It is not possible to guarantee to be able to scan all media types and sizes.

\*14 To return document to the front, use document return guides.

\*15 Document return guides and paper tray folded.

\*16 Power consumption is measured with scan resolution setting of 200 dpi.

**Canon**  
Delighting You Always

CANON SINGAPORE PTE. LTD.  
1 Fusionopolis Place, #14-10 Galaxis, Singapore 138522  
Tel : 65-6799-8888 | Fax : 65-6799-8882 | <https://asia.canon>

CANON BUSINESS PARTNER / DEALER'S STAMP

This document is for information purpose only. The contents are subject to change without notice. Product options, name and availability may vary by regions. We expressly disclaim any liability or contractual obligations with respect to this document. Brands and product names are trademarks and/or registered trademarks of their respective owners.

Warning: Unauthorised recording of copyrighted materials may infringe on the rights of copyright owners and be contrary to copyright laws.